



**Hultafors**



# Function and precision that you can feel in your hand.

Ask any professional user of tools you like. They'll tell you – "If you want the real deal, it has to be Hultafors." By choosing a Hultafors tool, you are getting a tool that delivers the best possible functionality, precision and quality.

The knowledge Hultafors has of professional users' workday is undeniably unique. As is the extensive experience. Since it all started with the now world-renowned folding rule in 1883, we have spent 130 years developing and manufacturing tools for professionals.

We offer a wide selection of hand tools for all types of professionals. Our products are developed in cooperation with professional users aiming to contribute to making the workday as smooth and efficient as possible.

Hultafors products are designed with your best interest in mind. We strive to develop long-lasting products in durable materials and with ergonomic design. This way we can maximize the life span of our products and at the same time minimize our environmental impact. Tools you can rely on in all situations, every day.

A black and white photograph of a person wearing a plaid shirt, using a Hultafors tool. The person's hands are visible, gripping the tool. The tool is dark-colored with the brand name 'Hultafors' printed vertically on its side. The background is dark and out of focus.

Hultafors

# Table of Contents

## Marking

DRY MARKERS .....	2
INK DEEP HOLE MARKERS .....	4
PENCILS .....	4

## Leveling

LEVELS .....	5
--------------	---

## Striking

HAMMERS .....	10
MALLETS & SLEDGES .....	12

## Chopping

HATCHET & AXE .....	13
---------------------	----

## Nail Pullers

NAIL PULLER .....	15
-------------------	----

## Knives

SNAP-OFF KNIVES & BLADES .....	16
UTILITY KNIVES & BLADES .....	21
KNIVES & HOLSTERS .....	24

## Chisels & Holsters

CHISELS & HOLSTERS .....	27
--------------------------	----

## Saws

TOOLBOX SAWS & JAB SAW .....	30
HACKSAWS .....	33

## Pry Bars & Wrecking Bars

WRECKING BARS .....	34
PRY BARS .....	37
BENDING BARS .....	39

## Tool Carriers

TOOL CARRIER .....	40
--------------------	----

## Rafter Square

RAFTER SQUARE .....	41
---------------------	----

## Clamps

CLAMPS .....	42
--------------	----

## Chalk

CHALK LINE, REFILL & PARTS .....	43
----------------------------------	----

## Make your mark.

THE NEXT GENERATION OF MARKERS.

Hultafors range of marking tools consists of both traditional carpenter pencils and the next generation of tools for marking. Our products are developed together with professionals and are designed for making your workday more efficient, no matter what material you are dealing with.

### DRY MARKER

Grip-friendly pencil in holster with built-in sharpener for clear markings.



### A new classic.

SHARP PENCIL, PRECISE MARKS.

At Hultafors, we pride ourselves on attention to detail. Our Dry Marker combines the shape of the traditional carpenter's pencil with the classic school pencil, so you can both draw rough lines and make precision marks. The design of the holster with a built-in sharpener makes the pencil easy to sharpen so that you always have a sharp tip close at hand.

### Need a refill?

GRAPHITE OR CHALK.

The design of the refill extends the life of the Hultafors Dry Marker. The Dry Marker refill comes with 10 leads for marking on all types of surfaces. The container protects the leads during transport and only ejects one lead at a time. The refill is available in two combinations; 10 leads in durable graphite or 4 graphite leads and 6 pieces in chalk, 3 red and 3 yellow.



# Dry markers.

## Dry Marker HDM



Model #650100

Grip-friendly pencil in holster for clear markings. The shape of the holster ensures that the pen stays in place even when you move. Accessible sharpener in the holster keeps dirt and moisture away from the pen for longer durability.

- Grip-friendly and ergonomic design.
- Roll stop on both pencil and holster.
- Sharp and accessible sharpener placed in the holster.
- Optimized lead for durability and resistance to moisture.
- Refill available with 10 leads in a smart container.
- Easy to change lead.

## Dry Marker Refills



Model #650110



Model #650110  
Packaging

Hultafors Dry Marker Refills can be attached with a clip in a pocket or tool bag. The design of the container protects the leads during transport. The refill is available in two combinations for all your marking needs.

- Refill with 10 leads for use with the Dry Marker HDM.
- Smart container design protects leads.
- Ejects one lead at a time.
- Two variants: graphite or graphite and chalk.
- Graphite leads are optimized for increased durability and resistance to moisture.

Material	Description	Model #
Graphite	Dry Marker Refills HRD G	650110

## Dry Marker Refills



Model #650120



Model #650130  
Packaging

Hultafors Dry Marker Refills can be attached with a clip in a pocket or tool bag. The design of the container protects the leads during transport. The refill contains three colours, graphite, red & yellow.

- Refill with 10 leads for use with the Dry Marker HDM.
- Smart container design protects leads.
- Ejects one lead at a time.
- Three variants: graphite, red and yellow.
- Leads are optimized for increased durability and resistance to moisture.

Colour	Description	Model #
Graphite/Red/Yellow	Dry Marker Refills HRD GRY	650120
Graphite/Red/Yellow	Dry Markers & Refills, Display Pack HDM RD	650130

# Deep hole markers & pencils.

## Ink Deep-hole Marker



Model #650310

Hultafors Ink Deep-hole Marker for use on most materials and surfaces. Ideal tool for marking in hard-to-reach places and narrow holes.

- Available in permanent red or black ink.
- For marking in hard-to-reach places.
- Works on most materials and surfaces.

Colour	Description	Model #
Black	Ink Deep-hole Marker HIDHM B	650310
Red	Ink Deep-hole Marker HIDHM R	650320

## Carpenter's Pencil



Model #650207

Carpenter's pencil made from linden wood with a medium-hard lead (HB), for optimal function on wood, plaster and other soft materials.

- Easy to sharpen as linden is a softwood with few transversal fibres.
- Medium-hard lead (HB) for optimal function on wood, plaster and other soft materials.
- Supplied in display box containing 200 pencils.

## Concrete Pencil



Model #650307

Concrete pencil made from linden wood with a very hard lead. Ideal if you need to mark hard surfaces such as stone and concrete.

- Easy to sharpen as linden is a softwood with few transversal fibres.
- Very hard lead (10 H) for optimal function on hard surfaces such as stone and concrete.
- Supplied in a practical display box

## Reaching a new level.

WHEN YOU NEED TOP LEVEL ACCURACY.

For professional tradesmen, a great spirit level is a vital tool for a job well done. Our spirit levels feature vials made from tough plastic that have a high level of transparency and durability. The fluid inside is a low viscosity oil mixture that is resistant to temperature fluctuations, ultraviolet light and static electricity. To guarantee accuracy, all our spirit levels are manufactured in accordance with a quality system compliant with ISO 9001.

### MST

Our strongest and most sensitive spirit level.

Made from strong aluminum.

Easy to clean.

70" length.

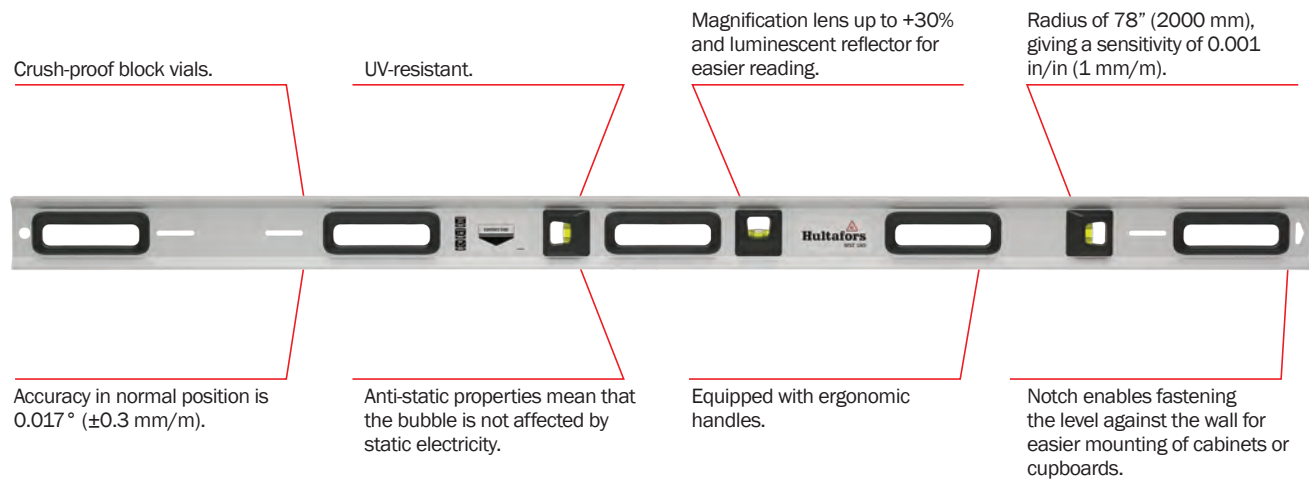

### High sensitivity.

#### LEVELS FOR THE TASK.

Certain tasks require a higher sensitivity, which is why we produce spirit levels with varying degrees of vial sensitivity. We offer spirit levels with 5 to 10 times higher sensitivity than the standard for more precise measurements. The more sensitive the vial is, the more accurate your work will be. If the vial is too sensitive, the level may be difficult to work with. MST is our most sensitive spirit level.

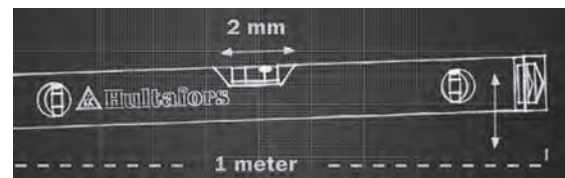
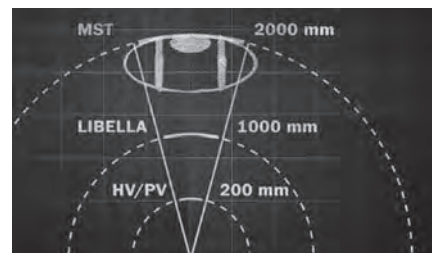

## Mini Pocket Level MPL Magnetic



Model #401313

Hultafors MPL Magnetic fits in any pocket, making it the perfect companion for everyday work. The strong magnet and V-groove edge facilitates measurement on flat or curved surfaces. It features a crush-proof focus vial with a +60% magnifying effect and a luminescent reflector for faster and better readability in dim light conditions.

- Compact size.
- Suitable for horizontal and vertical measuring.
- V-groove edge for measurement on flat or curved surfaces.
- Accuracy of  $0.049^\circ$  ( $\pm 0.75$  mm/m) in normal position.
- Crush-proof focus vial with magnifying effect.
- Magnetic edge..

## Mini Pocket Level MPL



Model #401303

Hultafors MPL pocket level features a vial with magnifying effect for fast and reliable horizontal measuring. MPL fits in any pocket, making it the perfect companion for everyday work. It features a crush-proof, horizontal vial with a +60% magnifying effect and a luminescent reflector for better readability in dim light conditions.

- Compact size.
- Suitable for horizontal measuring.
- Accuracy of  $0.058^\circ$  (1.00 mm/m) in normal position.
- Crush-proof block vial with magnifying effect.

## Spirit Level Aluminum MST 180



Model #402901

The 70" MST level is our strongest and most sensitive spirit level. Three crush-proof block vials that are UV-resistant and withstand temperature changes with a +30% magnification lens and luminescent reflector for easier reading.

- The radius of the vial is 78" (2000 mm), giving a sensitivity of 0.001 in/in (1 mm/m).
- Accuracy in normal position is  $0.017^\circ$  ( $\pm 0.3$  mm/m).
- The liquid in the vial is highly resistant to ultraviolet light and temperature fluctuations, giving the bubble optimal freedom of movement.
- Anti-static liquid protects bubble from static electricity.
- Holes in the aluminum frame for fastening the level against the wall for easier mounting of cabinets or cupboards.
- Easy to clean aluminum profile with ergonomic handles.



## Spirit Level Aluminum PV



Model #414001

Length	Vials	Description	Model #
16"	3	Spirit Level Aluminum PV 40	414001
24"	3	Spirit Level Aluminum PV 60	414101
32"	3	Spirit Level Aluminum PV 80	414201
48"	3	Spirit Level Aluminum PV 120	414401
78"	3	Spirit Level Aluminum PV 200	414701

Extra strong aluminum profile with transparent, durable crush-proof block vials and temperature-proof vial mountings. Horizontal and vertical vials are highly resistant to ultraviolet light and temperature fluctuations.

- Highly transparent focus vials for easier reading.
- Horizontal vial with a +30% magnification lens and luminescent reflector for accurate readings.
- Accuracy of 0.029° ( $\pm 0.5$  mm/m) in normal and upside down positions.
- Low viscosity colored oil mixture in vial gives the bubble optimal freedom of movement.
- Anti-static liquid protects bubble from static electricity.
- Shock absorbing end protectors with anti-slip function.

## Spirit Level Aluminum HV



Model #411001

Length	Vials	Description	Model #
16"	2	Spirit Level Aluminum HV 40	411001
24"	3	Spirit Level Aluminum HV 60	411101
32"	3	Spirit Level Aluminum HV 80	411201
48"	3	Spirit Level Aluminum HV 120	411401
72"	3	Spirit Level Aluminum HV 180	411601
78"	3	Spirit Level Aluminum HV 200	411701

Strong, easy to hold aluminum profile. Crush-proof block vials that are highly transparent and durable. Horizontal vial with a +30% magnification lens and luminescent reflector.

- Accuracy of 0.029° ( $\pm 0.5$  mm/m) in normal position, 0.049° ( $\pm 0.75$  mm/m) upside down.
- Low viscosity colored oil mixture in vial gives the bubble optimal freedom of movement.
- High resistance to ultraviolet light and temperature fluctuations.
- Anti-static liquid protects bubble from static electricity.
- Crush-proof, highly transparent vials for horizontal and vertical leveling.
- Shock absorbing end protectors.

## Digital Spirit Level Magnet DM



Model #408511

Description	Model #
Digital spirit level DM 60	408511
Digital spirit level DM 120	408521

Spirit level with a digital unit mounted in a robust aluminum box profile. For measuring inclination in different applications. The measurement area is 360°, split into four 90° zones. The vials have a +30% magnification lens and the horizontal vial has a luminescent reflector. Easy battery change and automatic shut-off after 5 minutes.

- Tolerance of vials in normal/ upside down position is  $\pm 0.5$  mm/m
- Shock absorbing end protectors with anti-slip function
- The display shows tenths of degrees, percentages, mm/m or inch/feet
- Electronic unit tolerance in horizontal (0°) and vertical (90°) position is  $\pm 0.05^\circ$ , for other angles  $\pm 0.1^\circ$
- Robust and strong magnets integrated in the profile

# Levels.

## Spirit Level ELV 40



Model #408605

Spirit level for electrical installations. The C-shaped aluminium profile has plastic end pieces and rubber spacers that protects and prevents the spirit level from sliding on the measuring surface. The sliding markers with graded 71mm centre spacing, allows for quick and accurate positioning when installing switch or junction boxes according to DIN 49075.

Description	Model #
Spirit Level ELV 40	408605

- Tolerance in normal position is  $\pm 0.5$  mm/m, upside down  $\pm 0.75$  mm/m.
- Focus vial with colour markings for easy reading and with a 200 mm radius giving a sensitivity of 10 mm/m.
- The liquid in the vial is a low viscosity coloured oil mixture that gives the bubble optimal freedom of movement.
- The anti-static properties of the liquid means that the bubble is not affected by static electricity.
- Printed millimeter grid scale on profile.

## Spirit Level IV 40 Magnet

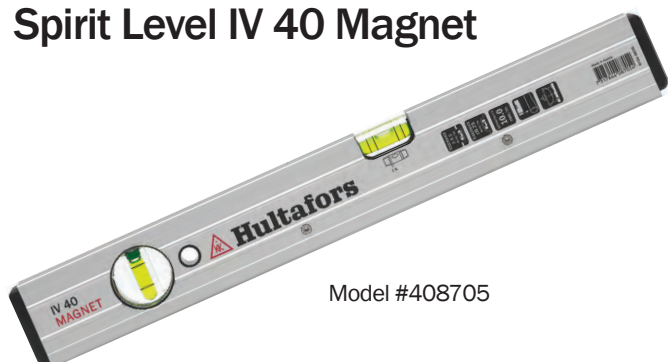

Model #408705

Spirit level for installation applications. Robust aluminium profile with neodymium magnets. This along with the V-shape of the profile allows for a strong hold on pipes and other metal surfaces. Center point scale on top of the profile for quick measurement and layout in different applications.

Description	Model #
Spirit Level IV 40	408705

- Tolerance in normal position is  $\pm 0.5$  mm/m, upside down  $\pm 0.75$  mm/m. Neodymium magnets integrated in the profile for strong magnetic force.
- The liquid in the vial is a low viscosity coloured oil mixture that gives the bubble optimal freedom of movement.
- Block Vial with additional rings for 2% inclination indication when measuring horizontally.
- Double vials for both horizontal and vertical measurement.

## Digital Spirit Level D



Model #408501

Spirit level with a digital unit mounted in a robust aluminum box profile. For measuring incline in different applications. The measurement area is 360°, split into four 90° zones. The vials are highly resistant to ultraviolet light and temperature fluctuations. The vials have a +30% magnification lens and the horizontal vial has a luminescent reflector. Easy battery change and automatic shut-off after 5 minutes.

Description	Model #
DIGITAL SPIRIT LEVEL D 60	408501

- Tolerance of vials in normal/ upside down position is  $\pm 0.5$  mm/m
- Shock absorbing end protectors with anti-slip function
- The display shows tenths of degrees, percentages, mm/m or inch/feet
- Electronic unit tolerance in horizontal (0°) and vertical (90°) position is  $\pm 0.05^\circ$ , for other angles  $\pm 0.1^\circ$

## Spirit Level Aluminium HVP Magnet



Model #400903

Description	Model #
SPIRIT-LEVEL HVP MAGNET 30	400753
SPIRIT-LEVEL HVP MAGNET 40	400803
SPIRIT LEVEL HVP MAGNET 60	400903
SPIRIT-LEVEL HVP MAGNET 120	401001

Strong aluminium profile measuring 49x23 mm and weighing 650g/m, with magnets on the underside. Crush-proof block vials that are highly transparent and durable. Horizontal vial with a magnification lens and luminescent reflector.

- The radius of the vial is 200 mm, giving a sensitivity of 10 mm/m.
- Tolerance in normal position is  $\pm 0.5$  mm/m, upside down  $\pm 0.75$  mm/m.
- The liquid in the vial is a low viscosity coloured oil mixture that gives the bubble optimal freedom of movement.
- Highly resistant to ultraviolet light and temperature fluctuations.
- The anti-static properties of the liquid means that the bubble is not affected by static electricity.

## Line Spirit Level UZ

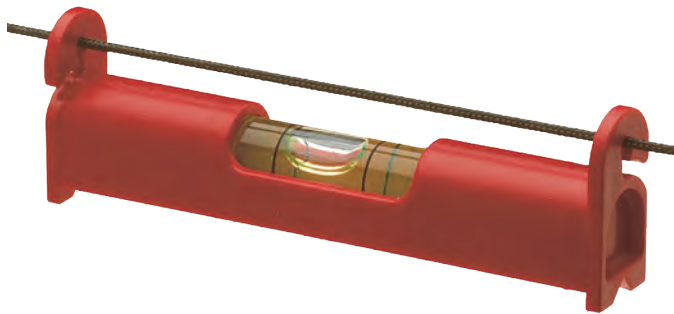

Model #402804

Small, neat line spirit level made from impact resistant plastic with a vial and hooks at both ends. Hang the level on a tensioned string to check the incline between two points.

- Made from ABS plastic, which makes the level both light and durable.
- The tubular vial is made from Plexiglas.
- The liquid in the vial is a low viscosity coloured oil mixture that gives the bubble optimal freedom of movement.

Product	Length	Model #
Line Spirit Level UZ	3.15"	402804

## Post Spirit Level JP



Model #404403

Post spirit level made from impact resistant ABS plastic, with three crush-proof tubular vials fitted to allow both horizontal and vertical measurement.

- The crush-proof vials have a radius of 180 mm, giving a sensitivity of 11 mm/m.
- The liquid in the vial is a low viscosity coloured oil mixture that gives the bubble optimal freedom of movement.
- Tolerance in normal position is  $\pm 2.0$  mm/m..

Product	Length	Model #
Post Spirit Level JP	3.5" x 5.5"	404403



## Straight Claw Hammer TR



Model #820220U

An ergonomically designed straight claw hammer forged in one piece for increased durability with a vibration damping urethane plug. The claw opening and angle give the best possible grip on the nail.

- Straight claw for better access and a longer shaft for more power for more demanding applications.
- Thin, strong claw for easy access without leaving marks.
- Vibration damping urethane plug.
- Right angle and shape of striking face.
- Steel shaft with I-profile for increased durability.
- Rounded claw to prevent tearing your pants.

Weight	Description	Model #
16 oz / 740g	Claw Hammer TR 16 XL	820220U
20 oz / 810g	Claw Hammer TR 20 XL	820240U

## Spirit Level LIBELLA 2000



Model #820120U

An ergonomically designed hammer forged in one piece for increased durability. The claw opening and angle give the best possible grip on the nail. Ergonomically designed handle with clear end stop and a secure grip.

- Vibration damping urethane plug.
- Right angle and shape of striking face.
- Steel shaft with I-profile for increased durability.
- Thin, strong claw for easy access without leaving marks.
- Rounded claw to prevent tearing your pants.

Weight	Description	Model #
16 oz / 740g	Claw Hammer TC 16 XL	820120U
20 oz / 810g	Claw Hammer TC 20 XL	820140U

## Spirit Level LIBELLA 2000



Model #823411U

Hammer head covered with urethane and a dead blow function using steel balls to cushion the shock and reduce recoil.

- Soft face protects job surfaces and equipment.
- Dead blow function uses steel balls to cushion the shock and reduce recoil.
- Ergonomic handle with rubber grip.
- Non-sparking, no exposed metal.
- Flat area on head allows upright storage.

Handle Length	Weight	Description	Model #
9.5"	1.3lb / 570g	Dead Blow Hammer DB 600	823411U
11"	2.6lb / 1160g	Dead Blow Hammer DB 1200	823412U
13.5"	3.6lb / 1650g	Dead Blow Hammer DB 1600	823413U
33"	12.6lb / 5700g	Dead Blow Hammer DB 5000	823414U

## Bricklayer's Hammer M



Model #822251U

Blasted and clear-lacquered ironwork, with tempered square striking face and wide, ground chisel.

- The hammer head is hand-forged with a tempered chisel and striking face.
- Notch for nail pulling.
- Remove plaster with ease.
- Hickory shaft.
- Steel head.

Weight	Description	Model #
1.8lb / 820g	Bricklayer's Hammer M 600	822251U

## Bricklayer's Hammer TB



Model #822281U

An ergonomically designed hammer forged as one piece for increased durability with a vibration damping urethane plug. Tempered square striking face and a strong ground chisel with a notch for pulling out nails.

- Right angle and shape of chisel for safe splitting of bricks.
- Steel shaft with I-beam for increased durability.
- Vibration damping urethane plug.
- Handle with a distinct end stop to ensure a secure grip.
- Tempered square striking face.
- Notch for nail pulling.

Weight	Description	Model #
2.0lb / 900g	Bricklayer's Hammer TB 600	822281U

## 61" Folding Ruler 61-1-16



Model #100704

A classic folding rule manufactured from downy birch with Swedish steel joints, affording thin sections and great flexibility. Scale with black figures on both sides, metric along the bottom edge and inches along the top edge.

- Coated with a water-based protective lacquer for increased resistance to dirt and moisture.
- The joints are heat-treated, coated and oiled at three points to ensure first-class performance.
- Made of downy birch.
- Scale with black figures on both sides.
- Ruler can be folded to the required length

# Mallets & Sledges

## Rubber Mallet

A mallet with black solid rubber head, hardness 80/90 shore.

- Ash shaft.



Model #823052

Weight	Description	Striker	Model #
0.7lb / 320g	Rubber Mallet	50mm	823052
1.2lb / 550g	Rubber Mallet	60mm	823053

## Sledge Double-Faced GF

Sledge made from blasted and clear-lacquered ironwork, with tempered square striking faces at both ends. Has an 850 mm long fibreglass shaft with a rubber grip.

- Made from high-grade steel, correctly tempered for the best possible level of user safety.
- Fibreglass shaft affords a greater level of safety and an extended service life.
- NOTE! Always wear protective goggles!



Model #825042

Weight	Description	Model #
11lb / 5000g	Sledge Double-Faced	825042

## Blacksmiths Sledge Double-Faced

Sledgehammer with black painted ironwork, tempered hexagon striking face on both sides. Wooden handle.

- NOTE! Always wear protective goggles!



Model #867001

Weight	Description	Model #
1.8lb / 4000g	Blacksmiths Sledge	867001



## Hultån Hatchet



Model #841701

Our classic trekking hatchet is the perfect outdoor companion, whether you are hiking in the wild or just need to work on the campfire. The hatchet comes in handy for almost any task in the forest, but first and foremost for camp site work, such as collecting and processing fire wood and building shelter.

- Wooden handle from American hickory, treated with linseed oil
- Convex grind edge
- The edge is sharpened, polished and ready to use
- Leather axe sheath included

Weight	Description	Model #
1.77lb / 805g	Hatchet	841701

## Ekelund Hunting Axe AB



Model #841710

With its ground neck and medium-weight head, our classic hunting is ideal for easier forestry work as well as for skinning game with great precision. This makes it your perfect hunting partner. It is also an ideal gift for any hunting enthusiast. The axe is hand forged and made from Swedish quality steel in the forge at Hults Bruk. The forging tradition goes as far back as 1697, and the steel head is struck 40-60 times to increase density and durability to the head. The name of this axe comes from Gunnar Ekelund, the squire who initiated axe production at a larger scale in Hults Bruk in 1870 - 1875. Take care of your axe and it will stay a faithful companion for many years to come. Thanks to the quality and craftsmanship of this axe, we offer you a full lifetime warranty on the axe head.

- Wooden handle from American hickory, treated with linseed oil
- Convex grind edge
- The edge is sharpened, polished and ready to use
- Leather axe sheath included

Weight	Description	Model #
2.67lb / 1210g	Ekelund Hunting Axe AB	841710

## Axe Handles Curved



Model #842701

Spare handle curved shape, made from american hickory, treated with linseed oil. Increase the life span for your axe by changing the handle when needed.

- Wooden handle from American hickory, treated with linseed oil

Handle Length	Fits To	Model #
16"	Axe 841701	842701
22"	Axe 840710	842710
27"	Axe 841720	842720

# Chopping

## Qvarfot Felling Axe



Model #841720

This is an axe well suited to assist you in small scale forestry. The long shaft adds force to the striking action and the axe is also useful for splitting, bucking and processing wood. The axe is hand forged and made from Swedish quality steel in the forge at Hults Bruk. The forging tradition goes as far back as 1697, and the steel head is struck 40-60 times to increase density and durability to the head. This axe is named after one of the families who served as blacksmiths at Hults Bruk for generations, the Qvarfot's. Take care of your axe and it will stay a faithful companion for many years to come. Thanks to the quality and craftsmanship of this axe, we offer you a full lifetime warranty on the axe head.

- Wooden handle from American hickory, treated with linseed oil
- Convex grind edge
- The edge is sharpened, polished and ready to use
- Leather axe sheath included

Weight	Description	Model #
1.87lb / 850g	Qvarfot Felling Axe	841720

## Grinding Stone Axe GS



Model #840792

With our grinding stone you can easily and securely grind your axe where ever you are. The grinding stone is of good size and designed to give a steady grip, protecting fingers and hands from cutting injuries. The elegant case in genuine leather protects your grinding stone, rendering it a long life. The rough side has a grain size of 180, and the fine side a grain size of 600. This is a good combination to regain sharpness to your axe. To make your work easier, we would recommend you to grind with water.

- Perfect for axes
- Coarse grit 180
- Fine grit 600
- 75mm diameter
- Total weight: 220 g

Grit	Description	Model #
600 / 180	Grinding Stone Axe GS	840792

## Nail Puller Atle

A versatile and easy-to-use nail puller. Despite its small size, the Atle can easily pull out a 5-inch nail, even when the head is off or buried deep in the wood.



Model #820030U

- Use with your carpenter's hammer and pull using the claw.
- Made from steel.
- Easily pull out a 5-inch nail.
- Great for pulling nails even when head is off or buried deep in the wood.
- Compact size.

Weight	Length	Description	Model #
1.3lb / 580g	8"	Nail Puller Atle	820030U

## Nail Puller Atle

VERSATILE AND EASY-TO-USE.

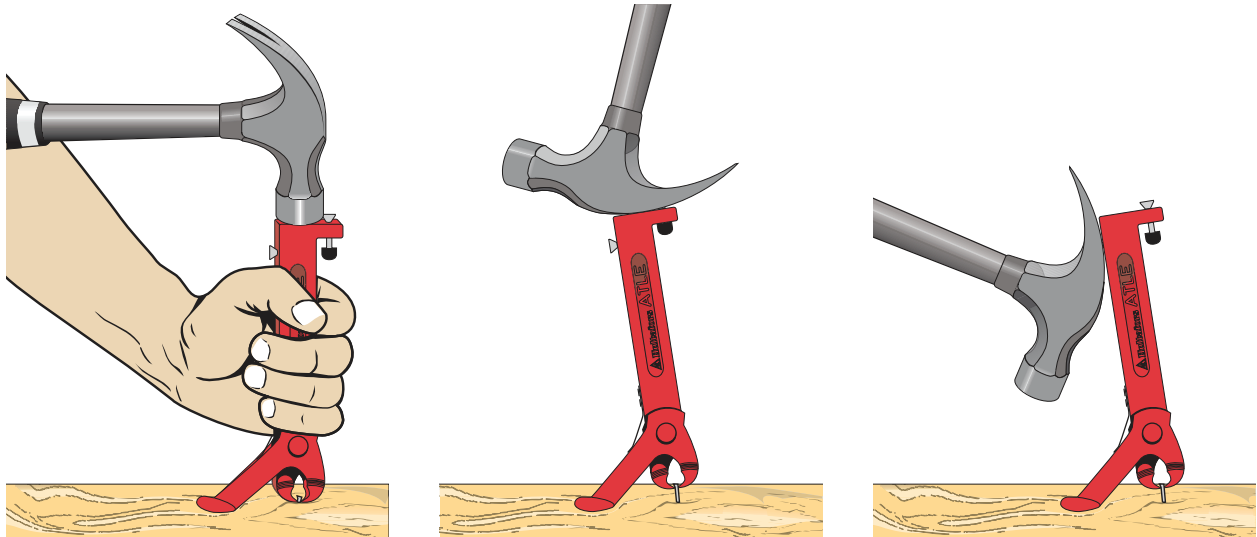

Atle is a versatile and easy-to-use nail puller that helps you pull out nails, even when the head is off or the nail is buried deep in the wood.

Atle is used together with your carpenter's hammer to pull out the nail. You just use the claw of your hammer.



## The sharpest choice.

### SHARP KNIVES FOR VARIED TASKS.

The most important feature of a knife is a sharp edge. With our complete range of snap-off knives you will always have excellent sharpness and precision close to hand, over and over again, without interruption. This means a more efficient workflow with fewer distractions for the professional craftsman. The snap-off knife is the perfect choice for jobs demanding extra sharpness, such as cutting cardboard, wallpaper or carpets.

#### SNAP-OFF KNIFE SFRP 18A/W

The SFRP 18A/W is an ergonomic snap-off knife with tail fin.



### Perfection in every cut.

#### PRECISION OR FLEXIBILITY.

Professional tradesmen demand professional knives with a sharp edge. With our snap-off knives you will have excellent sharpness and precision, over and over again, without interruption. We know that different tasks require different types of blades, so we offer an assortment of ergonomic snap-off knives and spare blades with different strengths to fit the task at hand. This means more efficient work with fewer distractions for the professional tradesman.

### Slim or rubberized grip?

#### DEPENDING ON THE JOB.

Our range of snap-off knives includes knives in slim version and versions with rubberized grip. The slimmer version offers you a sharp and precise knife in a compact format, taking up less space in the pocket. Knives with the rubberized grip are a better choice for materials demanding more power, like cutting in carpets, drywall or wood. The surface offers a better grip, especially if your hands are a bit wet. Also, the knives with rubberized grip can hold a dispenser with three spare blades.

# Snap-off knives & blades.

## Snap-off Knife SPP

The SPP is a robust snap-off knife for a wide range of jobs. Slim design is tapered for better visibility, access and control. The knife features 0.039" (1 mm) thick metal blade rail with durable plastic housing and steel core for added stability.



Model #389140U



Model #389150U



Model #389290U

- SPP 9A for cutting paper or opening boxes.
- SPP 18A/W for cutting plastic, drywall, stripping cables and removing silicone residue.
- SPP 25A/W for cutting thick carpets or insulation.
- Angled tip for estimating 45° & 90°.
- Symmetric design for right- and left-handed use.
- Slim design can be stored in pocket.

Lock	Blade Width	Blade Length	Description	Model #
Auto Lock	0.4" / 9 mm	3" / 80 mm	Snap-off Knife SPP 9A	389140U
Auto Lock	0.7" / 18 mm	4" / 100 mm	Snap-off Knife SPP 18A	389150U
Wheel Lock	0.7" / 18 mm	4" / 100 mm	Snap-off Knife SPP 18W	389160U
Auto Lock	1" / 25 mm	5" / 125 mm	Snap-off Knife SPP 25A	389280U
Wheel Lock	1" / 25 mm	5" / 125 mm	Snap-off Knife SPP 25W	389290U

## Snap-off Knife SFP

The SFP is a robust snap-off knife with a tail fin. The knife is suitable for all-round use. The slim design is tapered for better visibility, access and control. The knife features 0.039" (1 mm) thick metal blade rail with durable plastic housing and steel core for added stability.



Model #389170U



Model #389180U

- Angled tip for estimating 45° & 90°.
- The tail fin efficiently tucks carpets or opens cans.
- Symmetric design for right- and left-handed use.
- Slim design can be stored in your pocket.

Lock	Blade Width	Blade Length	Description	Model #
Auto Lock	0.7" / 18 mm	4" / 100 mm	Snap-off Knife SFP 18A	389170U
Wheel Lock	0.7" / 18 mm	4" / 100 mm	Snap-off Knife SFP 18W	389180U

## Snap-off Knife SRP

The SRP is an ergonomic snap-off knife for anything from all-round use such as cutting drywall, insulation and wood to cutting thick carpets or insulation. The design with rubberized grip makes it suitable for materials demanding more power. Tapered for better visibility, access and control. The knife features 0.039" (1 mm) thick metal blade rail with durable plastic housing and steel core for added stability.

- SRP 18A/W for cutting drywall, insulation and wood.
- SRP 25A/W for cutting thick carpets or insulation.
- Angled tip for estimating 45° & 90°.
- 0.039" (1 mm) thick metal blade rail for additional stability.
- Symmetric design for right- and left-handed use.
- Includes dispenser inside with 3 spare blades.



Model #389220U



Model #389270U



Model #389270U  
with integrated blade  
storage container

Lock	Blade Width	Blade Length	Description	Model #
Auto Lock	0.7" / 18 mm	4" / 100 mm	Snap-off Knife SRP 18A	389220U
Wheel Lock	0.7" / 18 mm	4" / 100 mm	Snap-off Knife SRP 18W	389230U
Auto Lock	1" / 25 mm	5" / 125 mm	Snap-off Knife SRP 25A	389260U
Wheel Lock	1" / 25 mm	5" / 125 mm	Snap-off Knife SRP 25W	389270U

## Snap-off Knife SFRP

The SFRP is an ergonomic snap-off knife with tail fin. The knife is suitable for all-round use such as cutting drywall, insulation and wood. The design with rubberized grip makes it suitable for materials demanding more power. Tapered for better visibility, access and control. The knife features 0.039" (1 mm) thick metal blade rail with durable plastic housing and steel core for added stability.

- Used for cutting drywall, insulation and wood.
- Angled tip for estimating 45° & 90°.
- The tail fin efficiently tucks carpets or opens cans.
- Symmetric design for right- and left-handed use.
- Includes dispenser inside with 3 spare blades.



Model #389240U



Model #389250U



Model #389250U  
with integrated blade  
storage container

Lock	Blade Width	Blade Length	Description	Model #
Auto Lock	0.7" / 18 mm	4" / 100 mm	Snap-off Knife SFRP 18A	389240U
Wheel Lock	0.7" / 18 mm	4" / 100 mm	Snap-off Knife SFRP 18W	389250U



## Snap-off Blade Allround

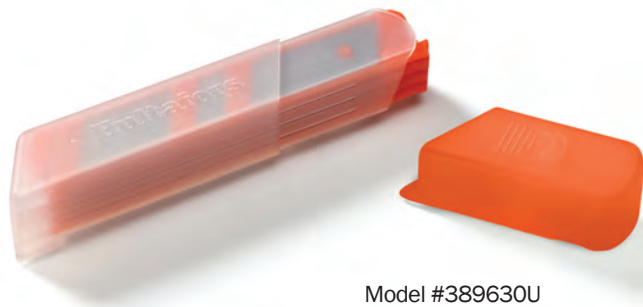

Model #389630U

A reliable blade for everyday cutting with excellent sharpness and long life. The box can be used for snapping blades and safely storing worn-out blades. Recycle worn-out blades as metal scrap.

- Used for cutting plastic, drywall, stripping cables and opening boxes.
- Graded to show how many fresh edges there are left.
- 8-12 sections per blade; the last blade can be used.
- 0.4" (9 mm) blade comes in a pack of 10.
- 0.7" and 1" (18/25 mm) blades come in storage box with four dispensers holding three spare blades each.
- The box can be used for snapping blades and safely storing worn-out blades.

Blade Width	Blade Length	Description	Model #
0.4" / 9 mm	3"	Snap-off Blade Allround SBA9-10	389530U
0.7" / 18 mm	4"	Snap-off Blade Allround SBA18-4X3	389630U
1" / 25 mm	5"	Snap-off Blade Allround SBA25-4X3	389650U

## Non-segment Blade

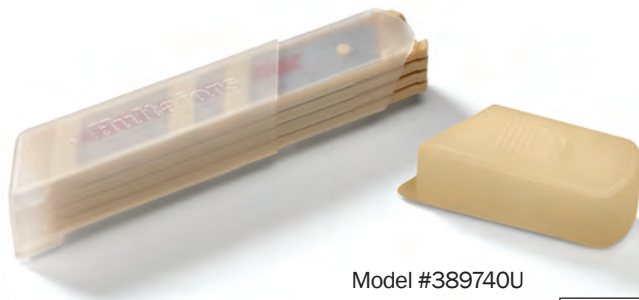

Model #389740U

A flexible blade for precision work close to the workpiece. Fits snap-off knives that use 0.7" and 1" (18/25 mm) wide blades. Recycle worn-out blades as metal scrap.

- Use for removing glue and silicone residue.
- Blade can be mounted for right or left-handed use.
- Dispenser can be used for snapping blades.
- Dispenser fits handle of SRP knives.
- Recycle used blades as metal scrap.

Blade Width	Blade Length	Description	Model #
0.7" / 18 mm	4"	Non-segment Blade SBN18-4X3	389740U
1" / 25 mm	5"	Non-segment Blade SBN25-4X3	389770U

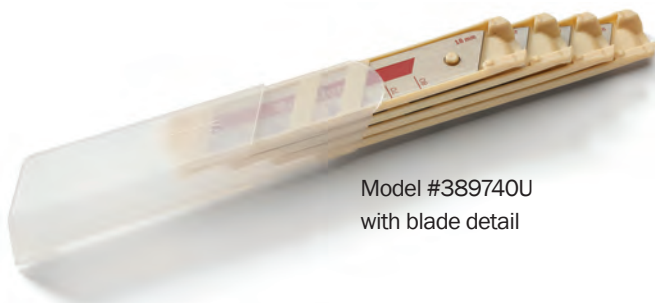

Model #389740U  
with blade detail

## Snap-off Blade Edge

A blade with extra sharpness for tasks demanding precision. The box can be used for snapping blades and safely storing worn-out blades.

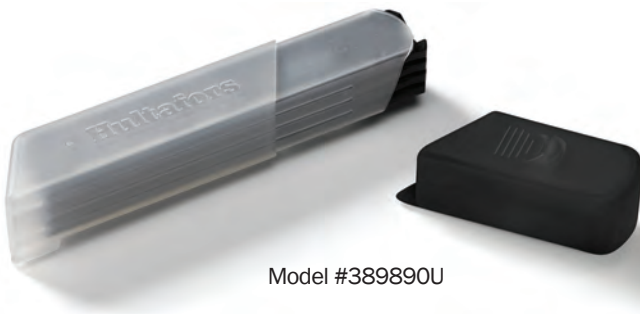

Model #389890U

- Developed for making precision cuts and when cutting drywall.
- Graded to show how many fresh edges there are left.
- 8-12 sections per blade; the last blade can be used.
- 0.4" (9 mm) blades come in a pack of 10.
- 0.7" and 1" (18/25 mm) blades come in a practical storage box with four dispensers holding three spare blades each.
- The box can be used for snapping blades and safely storing worn-out blades.

Blade Width	Blade Length	Description	Model #
0.4" / 9 mm	3"	Snap-off Blade Edge SBE9-10	389890U
0.7" / 18 mm	4"	Snap-off Blade Edge SBE18-4X3	389830U
1" / 25 mm	5"	Snap-off Blade Edge SBE25-4X3	389860U

## Snap-off Blade Performance

A blade with sharp long-life performance for tougher cuts. The box can be used for snapping blades and safely storing worn-out blades.

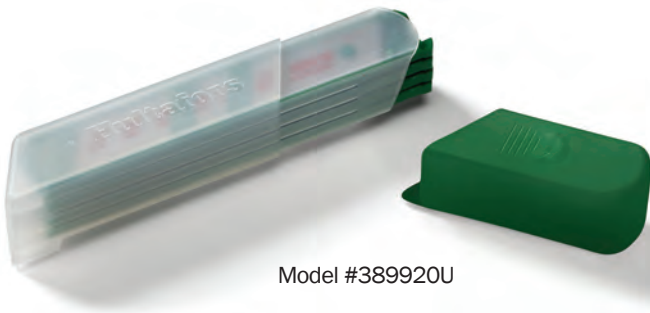

Model #389920U

- Developed for cutting insulation, drywall and carpets.
- Comes in a practical storage box with 4 dispensers holding 3 spare blades each.
- 8 sections per blade, the last blade can also be used.
- The box can be used for snapping blades and safely storing worn-out blades.

Blade Width	Blade Length	Description	Model #
0.7" / 18 mm	4"	Snap-off Blade Performance SBP18-4X3	389920U
1" / 25 mm	5"	Snap-off Blade Performance SBP25-4X3	389940U

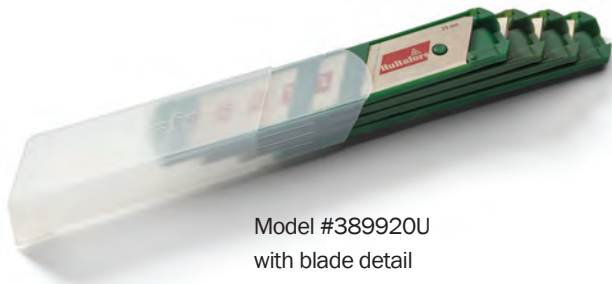

Model #389920U  
with blade detail

## Advanced knives.

### PLAIN AND SIMPLE.

A really good knife should fit perfectly in your hand and be easy to use. At the same time, it should be safe, reliable and have all the important functions. To make our utility knives as user-friendly as possible, we have eliminated all unnecessary components and minimized the number of moving parts. This not only extends the service life of the knife, as there are fewer parts that can break, it also makes it easier to keep the knives clean.

URA

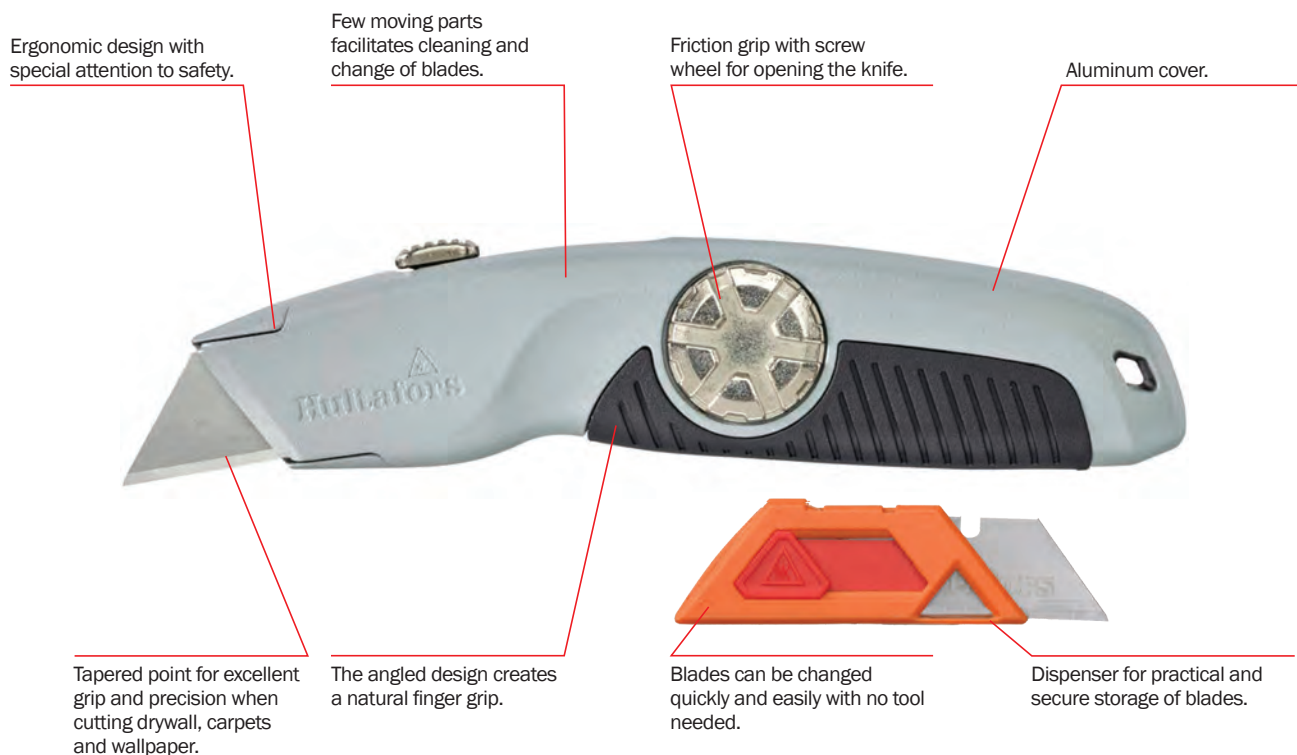

### Specialized blades.

#### BLADES WITH A PURPOSE.

At Hultafors, we know that one blade does not suit all needs. That's why we offer a range of blades engineered for specific purposes. The sharp Allround blade is a reliable choice for everyday cutting. The Performance blade is a great choice for big drywall jobs and offers extraordinary long-life performance. And finally, the Edge, a blade that brings extra sharpness for when the job demands higher than usual precision.

### Changing the blade.

#### STORING BOTH NEW AND WORN OUT BLADES.

On the inside of our utility knives we have placed a practical spring-loaded dispenser that holds five to ten spare blades. The dispenser can also store worn out blades so that you never have to think about where to place them. The blades can be changed quickly and easily with no extra tools required.



# Utility knives & blades.

## Utility Knife URA



Model #388020U

Light and efficient 6" utility knife with a great grip, ergonomically designed for best possible safety, comfort and control. Comes with 11 Allround blades; 10 blades in the dispenser stored inside the knife.

- Ergonomic, angled design with a natural finger grip and a tapered point for an excellent grip.
- Screw wheel for opening the knife with no tool needed.
- Practical spring-loaded dispenser holds 10 spare blades inside the handle.
- Few moving parts facilitates cleaning and change of blades.
- Dispenser can be used for safely storing used blades.

## Utility Knife URZ



Model #388050U

Sturdy and well-balanced 6" utility knife with ergonomic design for best possible safety, comfort and control. Comes with 11 spare Allround blades; 10 in dispenser stored inside the knife.

- Ergonomic, angled design with a natural finger grip and a tapered point for an excellent grip.
- Robust cover in zinc with screw wheel for opening the knife with no tool needed.
- Practical spring-loaded dispenser holds 10 spare blades inside handle.
- Few moving parts facilitates cleaning.
- Change blades simply and easily.
- Dispenser can be used for safely storing used blades.

## Insulation Knife FGK



Model #389010U

An Insulation knife with a 2" (50 mm) wide, flexible blade and scale. Serrated blade and grip-friendly handle made from impact-resistant plastic for easy cutting.

- Blade is made with 2" (50 mm) wide carbon steel.
- Serrated edge makes it easy to cut through all types of insulation.
- Handle and holster are made from durable PP plastic.
- Centimeter (cm) scale on the blade makes for quick measurements.
- Holster included.

## Utility Blade Allround



Model #388550U

Blade Qty	Description	Model #
10	Utility Blade Allround UBA-10	388550U
100	Utility Blade Allround UBA-100	388560U

A great blade with excellent sharpness and long life. Developed for all-round use wherever there is a need for cutting with precision and control. Used blades can be stored on the back of the dispenser to keep the workplace safe.

- Optimized for universal use to match the needs of professional tradesmen.
- Made from SK5 carbon steel hardened to 58-60 HRC.
- 10-blade or 100-blade options available.
- Stores used blades improving safety at the workplace.
- Spring-loaded dispenser. Push to dispense a new blade.
- 10-blade dispensers fit inside the handle of utility knives.

## Utility Blade Edge UBE-10



Model #388720U

A blade with extraordinary sharpness developed for tasks where the demand for precision is higher than usual. Sharper than our Allround blade though not as robust. Used blades can be stored on the back of the dispenser to keep the workplace safe.

- Extraordinary sharpness when regular sharpness is not enough.
- Made from SK2 carbon steel hardened to 58-60 HRC.
- 10 blades in pack.
- Spring-loaded dispenser. Push to dispense a new blade.
- Stores used blades improving safety at the workplace.
- Dispenser fits inside the handle of utility knives.

## Utility Blade Performance UBP-10



Model #388920U

A blade with extraordinary long-life performance. Made from hardened carbon steel for a greater sharpness and extended lifetime compared to the competition. A great choice for when big drywall jobs await.

- A hard and sharp blade with extra-long life.
- Made from German L22 carbon steel hardened to 61 HRC.
- 10 blades in pack.
- Spring-loaded dispenser. Push to dispense a new blade.
- Stores used blades improving safety at the workplace.
- Dispenser fits inside the handle of utility knives.

## Craftsman's Knife HVK



Model #380010

Knife developed and adapted to meet the needs of craftsmen, with a blade made from Japanese knife steel. It features a unique function for attaching the holster around a button on your work clothes so that it does not come loose whilst still being easy to remove. The blade is made from 2.5 mm carbon steel that has been hardened to 58-60 HRC.

## Painter's Knife MK



Model #380040

Knife for painters, designed for use as both a can opener and a slot screwdriver. It features a unique function for attaching the holster around a button on your work clothes so that it does not come loose whilst still being easy to remove. The blade is made from Japanese knife steel, 2.5 mm carbon steel that has been hardened to 58-60 HRC.

## Outdoor Knife OK4



Model #380270

A durable outdoor knife with friction grip suitable for tough tasks in the field. The hard wearing textile belt loop allows up to 80mm wide belts and is equipped with a pocket for a fire starter. The blade has a scandi grind and is made from Japanese knife steel, 3.0 mm carbon steel that has been hardened to 58-60 HRC and has a rust protective electrophoretic deposition coating to withstand corrosion. The grinded spine of the blade is designed for starting a fire with a fire starter.



## Knife Double Holster



Model #387030

Double holster including the chisel knife STK and the electrician's knife ELK. The chisel knife is a robust knife with V-shaped grinded chisel function. The sharpening of the blades different edges and the design of the handle of the electrician's knife is optimized for cable stripping. With these 2 knives close at hand, you can be sure to be well-equipped for all tasks. A double holster always allows you to have access to the two knives you use the most, and your job gets done efficiently. The double holster is made from impact-resistant PP plastic, joined by rivets and an elastic loop. Our double holster is also available in many different combinations. Once your knives are worn out, keep the holster and use it again for new knives. A great way to minimize our carbon footprint!

## Electrician's Knife



ELECTRICIAN'S KNIFE ELK (Right) Model #380030



ELECTRICIAN'S KNIFE ELK (Left) Model #383030

The sharpening of the blade edges and the design of the handle have been optimized for cable stripping. It features a unique function for attaching the holster around a button on your work clothes so that it does not come loose whilst still being easy to remove. The blade is made from Japanese knife steel, 1.5 mm carbon steel that has been hardened to 58-60 HRC.

- The two edges have been sharpened to be particularly effective when stripping cables.
- Both the handle and holster are made from super-durable PP plastic.
- The holster can be attached to both a belt and a button on your work clothes. If your belt is thick, cut away the small pin on the cover.
- ELK-L has a green handle with edges sharpened for left-handed use.
- Made with Japanese knife steel. 

## Double Holster JS & URA



Model #381060U

Double holster JS & URA includes the Job Saw JS and Utility Knife URA – the perfect combination for those working with drywall. A double holster allows you to have access to the two knives you use the most, so your job gets done efficiently.

- 5-inch Job Saw with graded scale for drywall cutting.
- JS features 3-phase grinding for high efficiency cuts without damage to surrounding materials.
- 6-inch URA Utility Knife for all-around use.
- URA's practical spring-loaded dispenser holds 10 spare blades inside the handle.
- Double holsters for different combinations of knives.
- Once the knives are worn out, keep the holster and reuse it with new knives.



## Award-winning chisels.

SHARP, RELIABLE AND ALWAYS ON HAND.

Chisels have always had a prominent place in the tool kits of professionals. It has often been regarded as an all-round tool used for everything from cutting and prying to scraping. When we developed our range of chisels, we looked at what professional tradesmen need in their daily work. The result was a series of high-quality chisels for tradesmen who want something extra in terms of strength, function and precision. The robust design offers outstanding strength and impact resistance to ensure a sharp reliable tool that is always on hand.

### CHISEL HDC

Durable nylon striking face.

Forged in one piece for extremely high breaking capacity and impact resistance and for better transfer of power.

Smart holster for easy access at all time.



reddot design award  
winner 2008



Santoprene handle for perfect grip and precision.

Can be placed flat against the work surface, enabling material to be removed without damaging the underlying surface.

Made from double-tempered high-quality steel.

Sharpened into a 25° angle for optimum balance between sharpness and durability.

### HDC CHISELS

When we observed tradesmen at work, it quickly became apparent that they needed a chisel that is easy to carry and can be used for various types of work. These tradesmen called for extremely high quality chisels, which were previously absent from the market. With their needs in mind, we developed the Hultafors HDC Chisel – a unique chisel with a uniform steel construction, forged in a single piece. A highly robust, sharp and durable chisel for tradesmen who want something extra in terms of strength, function and precision.



# Chisels & holsters.

## Chisel HDC



Model #390273U

**Holster included**

Blade Width	Description	Model #
0.75" / 20 mm	Chisel HDC 20	390263U
1" / 25 mm	Chisel HDC 25	390273U
1.25" / 32 mm	Chisel HDC 32	390283U
1.5" / 40 mm	Chisel HDC 40	390293U

The HDC 10" Chisel is a heavy duty, sharp tool that is ready for tasks requiring extreme strength and precision. A perfect ground blade beveled at 25° for the best ratio possible between sharpness and durability. The entire chisel including the handle can be positioned flat against the surface for expanded uses. Smart holster made from durable plastic can be attached to a belt or on a button for easy accessibility.

- Continuous I-beam for extreme durability and to maximize the force transmission to the work piece.
- Blade made from high-quality steel, perfectly sharpened into a 25° angle.
- Flat contact surface for a number of applications.
- Ergonomic plastic handle optimized for both power and precision.
- Holster made from durable plastic with holes for better ventilation.

## Chisel Knife STK



Model #380070U

Robust 8" knife with V-ground chisel function offers two tools in one. STK features a unique function for attaching the holster around a button on your work clothes so that it does not come loose while still being easy to remove.

- Sharpened cutting edge.
- Blade made of Japanese 3 mm carbon steel hardened to 58-60 HRC.
- Continuous I-beam for extreme durability.
- Handle and holster are made from durable PP plastic.
- Holster can be attached to both a belt and a button on your work clothes.

## Holsters

SAFE ATTACHMENT TO BOTH BELT AND BUTTON.

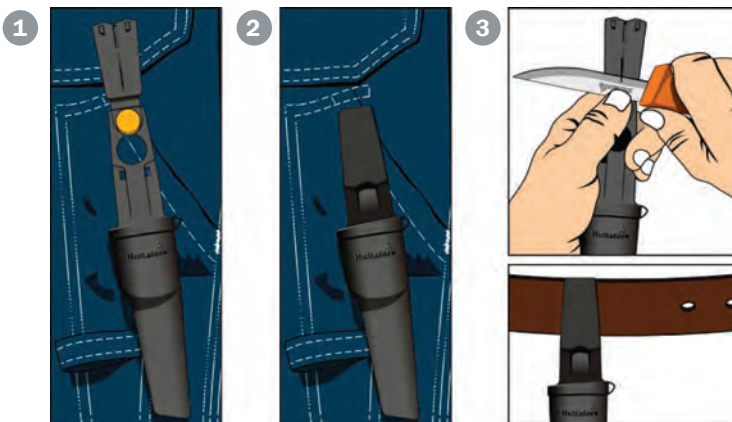

1. You simply attach the holster to a button on your pants using a unique function that ensures the holster doesn't come loose while still making it easy to remove.
2. Insert the button into the hole, pull the holster down and snap the cover firmly in position. To remove the holster, just undo the cover.
3. The holster can also be worn on a belt. If you have a thick belt, you may need to cut off the pin on the cover.



## Double Holster STK & URA



Model #381070U

Double holster STK & URA allows you to have access to the two knives you use the most, so your jobs get done efficiently. The STK chisel knife is two tools in one offering a robust knife with a V-shaped ground chisel function. The ergonomically designed URA utility knife offers great grip when cutting drywall, carpets and wallpaper.

- Chisel Knife STK is a robust knife for simpler woodwork.
- 8-inch STK features a sharpened V-ground cutting edge.
- 6-inch URA Utility Knife is for all-around use.
- URA's practical spring-loaded dispenser holds 10 spare blades inside the handle.
- Double holsters for different combinations of knives.
- Once the knives are worn out, keep the holster and reuse it with new knives.

## Chisel EDC



Model #390033

An everyday chisel, sharp, reliable and always at hand. Ready for tough precision and all-round use, from adjusting and xquality Japanese steel blade with heavy-duty handle designed for hard hammer blows. Smart holster with a clip for easy access at all times.

- High-quality Japanese steel blade.
- Rust protected by Electrophoretic deposition (EPD).
- Very robust handle.
- Smart holster for protection and easy access.

Blade Width	Description	Model #
6 mm	CHISEL EDC 6	390013
10 mm	CHISEL EDC 10	390023
12 mm	CHISEL EDC 12	390033
16 mm	CHISEL EDC 16	390043
18 mm	CHISEL EDC 18	390053
20 mm	CHISEL EDC 20	390063
25 mm	CHISEL EDC 25	390073
32 mm	CHISEL EDC 32	390083

## Chisel Set EDC



Model #390005

Set of 5 chisels in various sizes, gathered in a practical canvas bag. An everyday chisel, sharp, reliable and ready for all-around use, such as adjusting and fitting to prying and demolishing. Perfectly sharpened high-quality Japanese steel blade with heavy-duty handle designed for hard hammer blows.

- Stored in a practical canvas casing.
- High-quality Japanese steel blade.
- Rust protected by Electrophoretic deposition (EPD).
- Heavy-duty handle.

Blade Width	Description	Model #
6 - 10 - 12 - 16 - 25 mm	CHISEL SET EDC	390005

## Precision in every cut.

A GOOD SAW IS ALL ABOUT EFFICIENCY

Hultafors offers a complete range of handsaws for any type of challenge and all types of jobs. Our saws come in different designs; handsaws, hack saws and various special saws for cutting most materials, including wood, metal, concrete and drywall. The common denominator for all our saws is precision and control, as we know professional tradesmen expect a great deal from their saws.

HBX

Environmentally friendly wax-coating for low friction and vibration.

Protected against rust.

Made from recycled steel.

Covered with rubber for a perfect grip.



reddot design award  
winner 2008

### Choose the right saw.

WHAT IS YOUR CHALLENGE?

#### HANSAW

Our handsaws ensure you will get the job done and are a reliable choice for all-round cutting as well as precision work. Our different models are customized depending on how frequently they are used and for what tasks. All our handsaws are made in durable material and with the professional user's efficiency in mind.

#### HACK SAW

Our hack saws are the perfect choice when you need to do precision work. All our hack saws come in handy sizes, from pocket size up to 12 inch. Thanks to high blade tension, they all deliver precision cuts without compromising on efficiency.

## Handsaw HBX-22-9



Model #590903U

22-inch HBX Handsaw features unique teeth with 3-phase grinding that combines efficiency and a good bite with nice straight cuts without chipping. Quick-release blade protection, ergonomic handle and exchangeable blades. The 0.039" (1 mm) thick steel blade with an eco-friendly coating gives less friction and power-consuming side vibrations. Durable three-component handle has a comfortable ergonomic grip.

- Unique teeth (9 TPI) with 3-phase grinding combines efficiency and a good bite without chipping.
- Environmentally friendly wax coating reduces friction and minimizes the risk of pinching.
- Reliable and secure system for changing the blade.
- Ergonomic handle with rubber grip and 45° and 90° angle guide.
- Robust blade protection with quick release function.

---

## Toolbox Saw HBX-14-11-S



Model #590750U

Professional 14-inch short saw for increased mobility and flexibility. The blade features eco-friendly wax-based coating that provides low friction and good rust protection. The teeth of the saw blade are hardened to give a long life and fine cuts, making this product ideal for precision work.

- Unique teeth (11 TPI) with 3-phase grinding combines efficiency and a good bite without chipping.
- 0.039" (1 mm) thick steel blade.
- Ergonomic handle with rubber grip and 45° and 90° angle guide.
- Robust blade protection with quick release function.
- Reliable and secure system for changing the blade.
- Environmentally friendly wax-based powder coating.

## Handsaw HBS



Model #590724

A standard saw for universal use with a fiberglass reinforced handle, rubber grip and 45° and 90° angle guide. The handle is mounted with screws for increased durability. The saw blade is made of 1mm thick steel which gives extra stability, precision and low vibrations. Hardened teeth with standard 2-phase grinding for efficiency and a long life time. The narrow blade tip facilitates access in narrow spaces and when to start cutting in the middle of a board.

- Blade of 1mm thick steel provides extra stability, precision and low vibration.
- Fiberglass reinforced handle with rubber grip.
- Basic but durable blade protection included.
- Handsaw HBS is available in a 10-pack or 45-pack display box.
- More to explore

Blade Length	Description	Model #
22" / 550mm	HANSAW HBS HBS-22-7	590724

## Jab Saw JS



Model #591260U

A 5" jab saw designed for cutting drywall. The blade is made in 0.062" (1.6 mm) high-quality steel for increased stability and precision. The blade is 3-phase ground to secure high efficiency without damaging surrounding materials. The blade is anti-rust treated, so do not forget to clean the blade and protect it with oil to maintain the protection over time.

- 5-inch jab saw for drywall cutting.
- 3-phase grinding for high efficiency cuts without damage to surrounding materials.
- Anti-rust treated 1.6 mm thick steel blade.
- Graded scale on the blade.
- Ergonomic handle with hole to attach a securing



# Hacksaws

## Hacksaw HMS-12



Model #591310U

A 12" steel frame hacksaw for precision, performance and high blade tension. The ergonomically shaped handle is made from cast aluminum and complemented with a grip friendly plastic support at the front of the frame. The blade can be tilted for cutting close to a flat surface without loss of performance and precision.

- Steel frame.
- Very high blade tension.
- Ergonomic handle with aluminum grip.
- Spring-loaded blade tensioner.
- Blade can be tilted for cutting close to a flat surface.
- Hultafors 12-inch BI-metal blade (24 TPI) included.

## Hacksaw HMX-12



Model #591300U

A professional 12" hack saw with a stiff and compact cast aluminum frame for low weight, maximum performance and very high blade tension. The handle is ergonomically shaped with a rubber grip to maximize user friendliness. The blade can be tilted for cutting close to a flat surface without loss of performance and precision.

- Compact cast aluminum lightweight frame.
- Very high blade tension.
- Ergonomic handle with rubber grip.
- Spring-loaded blade tensioner.
- Blade can be tilted for cutting close to a flat surface.
- Hultafors 12-inch BI-metal blade (24 TPI) included.

## Hacksaw HMS-12



Model #591340U

12" Spare Blade for Hacksaw with 18 TPI (rough/medium) or 24 TPI (medium) for cutting metal bars, profile and tubes. High performance and durable bi-metal blade.

- Options of 18 or 24 teeth per inch.
- 12" blade.
- 2 blades in pack.

Teeth/Inch	Description	Model #
18	Hacksaw Spare blade HM-12-18x2	591340U
24	Hacksaw Spare blade HM-12-24x2	591350U

## Demolish with quality.

### WIDE RANGE OF WRECKING BARS.

When completing demolition work, it's important to choose a tool with adequate leverage and good ergonomics. Hultafors wrecking bars rise to the challenge. We produce a wide range of different bars, including pry bars, wrecking bars and bending bars, in several different designs, sizes and materials so that you can always find the perfect tool for your job.

#### WRECKING BAR STEEL ADJUSTABLE 209 SB

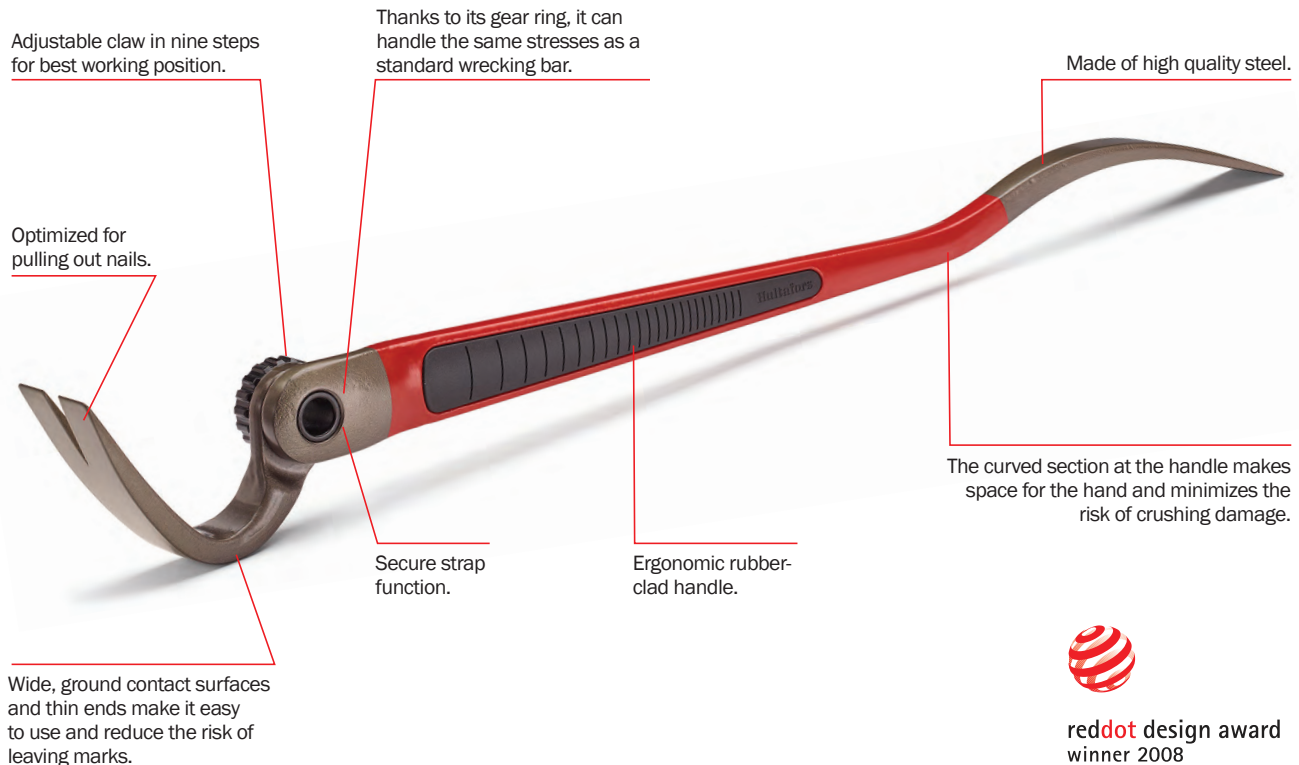

### Steel or aluminum.

#### WILL OF STEEL OR FLEXIBLE AS ALUMINUM

Steel is almost three times as heavy as aluminum, but it is also three times as strong. When doing work where weight and power is critical to achieving a good result, steel is the obvious choice. Aluminum is easier to work with and gentler on the materials. It doesn't rust, is more resistant to cold and is much more flexible. An aluminum tool can be "bent" about three times as much as a steel tool without becoming deformed, making it ideal for fitting and adjusting construction materials.

### Ergonomical tips.

#### BE KIND TO YOUR BODY.

To help you steer clear of any injuries, we've come up with a few tips. Always work with a straight back but try to avoid working with straight arms. You should also avoid working with bent wrists. The best thing to do is to try and change your work posture as often as you can. Also try to avoid getting into too many situations that involve jerking and wrenching. It's also good to know that aluminum is considerably gentler on your body, particularly when working at shoulder height or above.

# Wrecking bars.

## Wrecking Bar Steel 109

Wrecking bar made from hardened, high-alloy boron steel that will bend but will not break. Wide, ground contact surfaces and thin ends make it easy to use in narrow spaces and reduce the risk of leaving marks.



- Made from hardened, high-alloy boron steel.
- Wide, ground contact surfaces and thin ends allow easy access in narrow spaces.
- Unpainted ends reduce leaving marks.
- The claw is optimized for pulling out nails.
- High-visibility powder coated finish.
- No sharp edges on bar.

Length	Weight	Description	Model #
12"	1lb / 450g	Wrecking Bar Steel 109/12"	824009U
20"	2.4lb / 1100g	Wrecking Bar Steel 109/20"	824010U
25"	3.2lb / 1450g	Wrecking Bar Steel 109/25"	824011U
28"	4.3lb / 1950g	Wrecking Bar Steel 109/28"	824012U
36"	6.3lb / 2850g	Wrecking Bar Steel 109/36"	824013U

## Wrecking Bar Steel 108

A small, versatile steel wrecking bar that can be used for pulling out nails and for breaking, scraping and lifting.



- Thin contact ends allow easy access in narrow spaces.
- Unpainted ends reduce leaving marks.
- Attractive, highly visible red finish.
- Has three functions for pulling out nails.
- Can be used for breaking, scraping and lifting.

Length	Weight	Description	Model #
15"	1.4lb / 650g	Wrecking Bar Steel 108/15"	827013U
21"	2lb / 860g	Wrecking Bar Steel 108/21"	827043U

## Wrecking Bar Steel 108 MINI

A small, useful steel 7.5" wrecking bar for finish carpenters that work with smaller pieces such as trim work. Can also be used to pull small nails, remove wood strips or to open cans.



- Attractive, highly visible red finish.
- Has three functions for pulling out nails.
- Thin contact surfaces for easy use in narrow spaces.
- Unpainted ends reduce leaving marks.
- No sharp edges on bar.

Length	Weight	Description	Model #
7.5"	0.2lb / 77g	Wrecking Bar Steel 108 MIN	827023U

## Wrecking Bar Steel Adjustable 209 SB/25"

Wrecking bar manufactured in high quality steel with ergonomic rubber-clad handle. Articulated claw adjustable to nine different positions features notched end ideal for pulling out nails. The curved section at the chisel makes space for the hand and minimizes the risk of crushing damage.



Model #824115U

- Adjustable claw in nine steps for best working position.
- Wide, ground contact surfaces and thin ends allow access in narrow spaces and reduce the risk of leaving marks.
- Adjustable to ensure optimum working position.
- Forged I-beam profile and hardened the entire length.
- Secure strap function for working at heights.
- Easily break up wooden floors, lift doors or adjust construction framework.
- Ergonomic rubber-clad handle ensures firm and comfortable grip.
- No sharp edges on bar.

Length	Weight	Description	Model #
25"	3.8lb / 1730g	Wrecking Bar Steel Adjustable 209 SB/25"	824115U

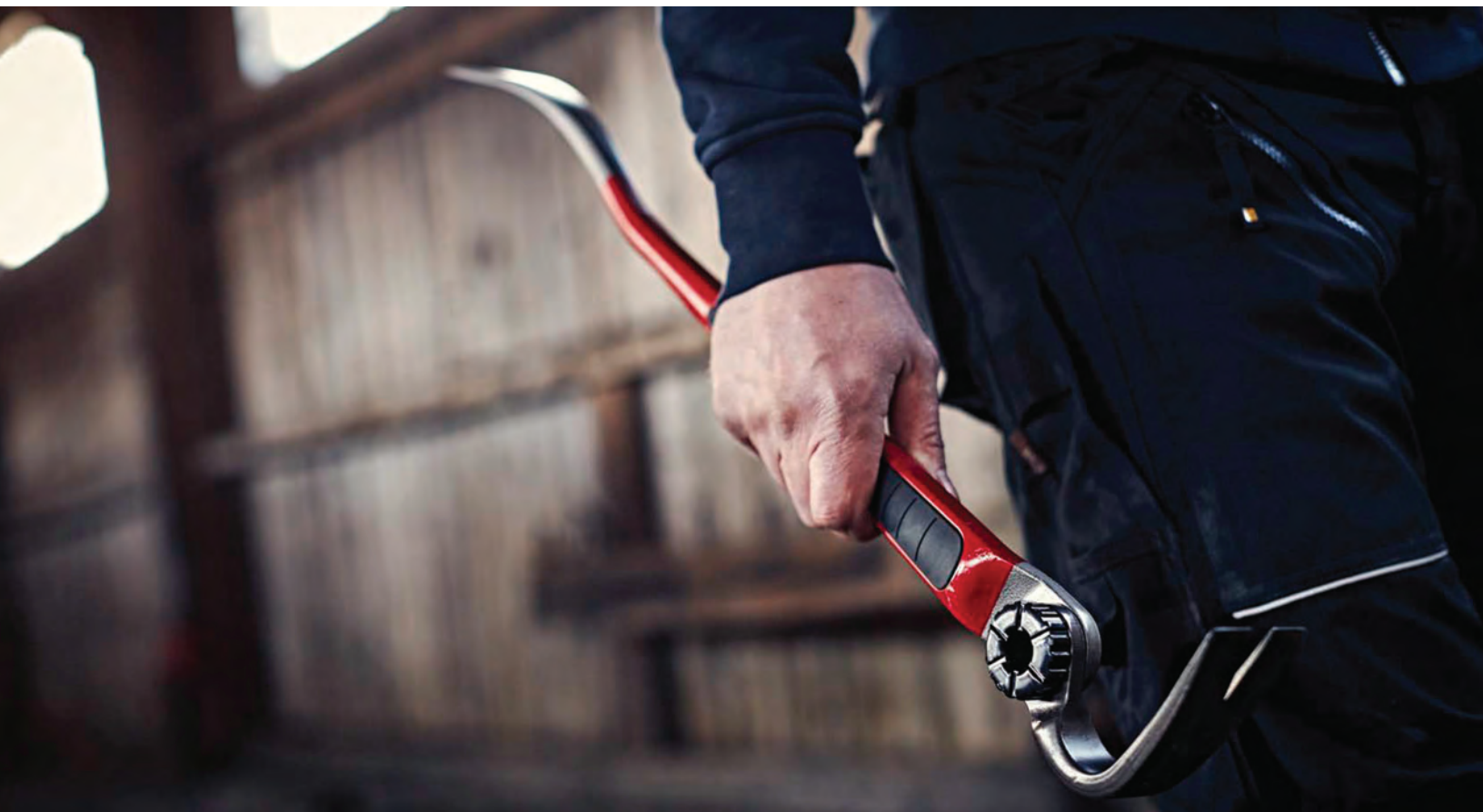



# Pry bars.

## Pry Bar Aluminum, with Pinch Point

Lightweight pry bar able to withstand high breaking loads. The bent point prevents trapping your fingers close to the floor.



Model #841024

- Manufactured in aerospace aluminum for high strength and less flexing.
- Lighter and easier to work with, especially when working at shoulder height.
- An aluminum tool that does not rust and has a better resistance to cold.
- It can be bent about three times as much as a steel tool without being deformed.
- Long lasting hardened steel SB-27 tip.

Length	Weight	Description	Model #
59"	7lb / 3200g	Pry Bar Steel Adjustable, with Pinch Point A 1500 SB	841024

## Pry Bar Aluminum, with Steel Point

An aluminum pry bar that also can endure breaking work. Long lasting SB-27 hardened steel tip used to cut and strike. Lightweight aluminum body for less user fatigue. This tool combines strength and flexibility; can flex under loads or spring back from shock of impact.

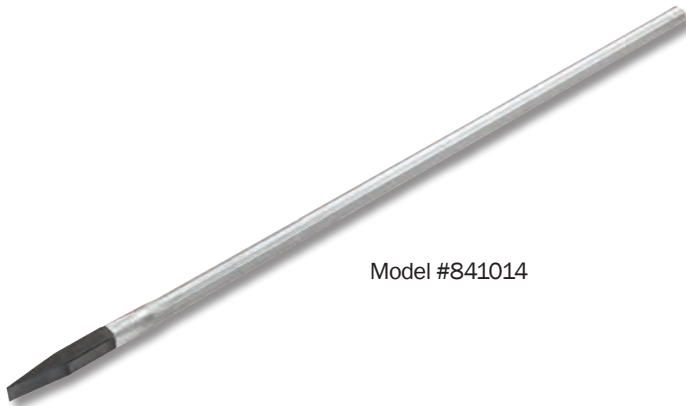

Model #841014

- Manufactured in aerospace aluminum for high strength and less flexing.
- Lighter and easier to work with, especially when working at shoulder height.
- Non-corrosive aluminum does not rust and is well suited for cold temperatures.
- Can be bent about three times as much as a steel tool without being deformed.
- Long lasting SB-27 hardened steel tip used to cut and strike.
- Lightweight aluminum body for less user fatigue. Tool that combines strength and flexibility, can flex under loads or spring back from shock of impact.

Length	Weight	Description	Model #
59"	8lb / 3600g	Pry Bar Steel Adjustable, with Pinch Point A 1500 SR	841014

## Pry Bar Steel SP



Model #826005

Steel pry bar that can handle high loads and work on stony and hard ground.

- The bar is made from high-grade steel to ensure the best possible level of user safety.
- Model SP 7 PIK is 1500 mm and spike sharpened.

Length	Description	Model #
59" / 1500mm	IRON BAR SP 7	826005

## Pry Bar Steel BLS



Model #843020

Steel pry bar with a steel ball welded onto the handle.

- Made from high-grade steel to ensure the best possible level of user safety.

Blade Length	Description	Model #
45" / 1150mm	STEEL PRY BAR BLS 1150	843020



# Bending bars.

## Bending Bar Aluminum F 430 & F 820

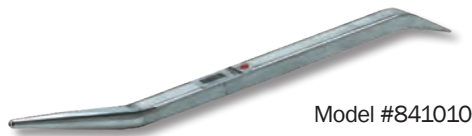

Model #841010



Model #841011

Aluminum bending bar with cone shaped tip. Used to fit flanges together with bolt holes and to gently bend copper pipes.

- Light aluminum bending bar that is easy to work with. Gentler to the material you work with.
- An aluminum tool that does not rust and can better withstand cold conditions.
- Cone shaped tip.
- Used to fit flanges together with bolt holes and to gently end copper pipes.

Length	Weight	Description	Model #
17"	1lb / 400g	Bending Bar Aluminum F 430	841010
32"	3.75lb / 1700g	Bending Bar Aluminum F 820	841011

## Bending Bar Aluminum H 480 B

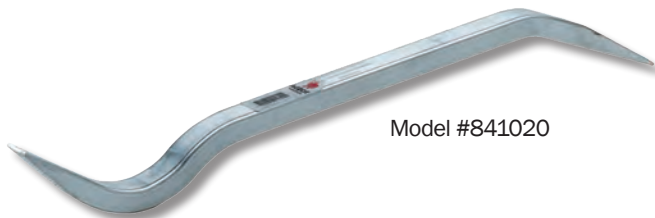

Model #841020

Aluminum bending bar with bent tip. This is a shorter version of the H 700 pry bar, designed to fit in a toolbox. Usually used in car workshops to adjust wheel alignment.

- Light aluminum bending bar that is easy to work with.
- Gentler to the material you work with.
- An aluminum tool that does not rust and can better withstand cold conditions.
- Compact size can fit in toolbox.

Length	Weight	Description	Model #
19"	1lb / 500g	Bending Bar Aluminum H 480 B	841020

## Bending Bar Aluminum H 700 & H 700 B

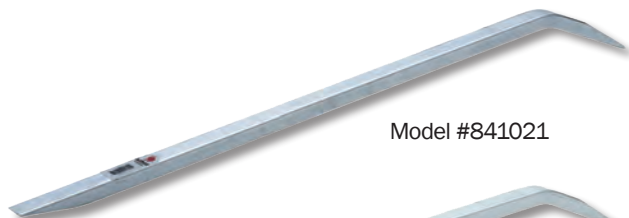

Model #841021

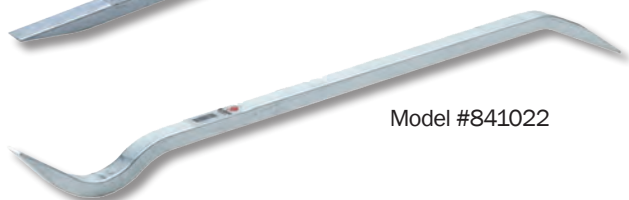

Model #841022

Aluminum bending bar used as a practical tool within construction industries. The H 700 for removing ice from wheels and testing the brakes on train carriages. The H 700 B produced to test wheel bearings on cars, but also used by locksmiths to adjust door fittings.

- Light aluminum bending bar that is easy to work with.
- Gentler to the material you work with.
- An aluminum tool that does not rust and can better withstand cold conditions.

Length	Weight	Description	Model #
27"	1.5lb / 700g	Bending Bar Aluminum H 700	841021
27"	1.5lb / 700g	Bending Bar Aluminum H 700 B	841022

## A smarter way to carry.

### A smarter way to carry.

The classic toolbox is often left behind in the craftsman's van or trailer. Instead many craftsmen put the few tools they expect to use in a regular bucket – a simple and practical solution yet with many limitations, not least when it comes to ergonomics. Hultafors Tool Bucket is as simple as it is clever. With its smart details, ergonomic shape and comfortable handle, you get a tool carrier that saves both your body and your wallet. For an easier workday and a professional appearance.

### Ergonomical design.

#### SAVING YOUR BODY.

The rear side of the tool bucket is shaped in order to improve the ergonomics when carrying it. The back is rounded so you can carry it close to the body without bouncing against it on every step. The handle is comfortable and could be placed in an upright position in order to simplify the next lift of the tool bucket. As a bonus, the tool bucket is stackable and equipped with a measuring scale on the inside.

#### TOOL BUCKET



### Tool Bucket TB-15

Ergonomic 4 gallon tool bucket made of robust PP-plastic material for versatile use such as carrying tools or necessities. The rear side is shaped in order to improve the ergonomics when carrying the product. The handle is comfortable and could be placed in an upright position in order to simplify the next lift of the tool bucket. The tool bucket is stackable and equipped with a measuring scale on the inside.

Volume	Description	Model #
4 gallon	Tool Bucket TB-15	590101

- Robust handle for comfortable carrying. Handle can be put in standing position when put down.
- Rounded back offers room for leg and body when carrying.
- Holes for attaching a shoulder strap.
- Measuring scale on the inside for multifunctional use.
- Can carry up to 200 pounds.
- Made of durable PP-plastic for long-life.



## Rafter Square



Model #257010

**Model with inch markings  
available in 2021.**

The Rafter Square is a robust and versatile tool for all craftsmen. It features a solid aluminum body with CNC-machined edges for greater accuracy and durability. The tool allows you to make fast and precise 45° and 90° markings. In addition, its thick edge is useful as a saw guide – it can be used directly with the saw against the square for cross cuts or angled cuts. This highly versatile tool can be used indirectly as well, using the scribing notches to create a pencil line or for when cutting plaster with a knife. The Hultafors Rafter Square can also be used as a protractor, for easily finding and marking various common angles. The tool has scales for cutting hip, valley and jack rafters.

- Solid aluminum body with CNC-machined edges for greater accuracy and durability.
- Low-glare protective anodized finish.
- Graduations are laser etched, highly resistant to wear and numbers are highly visible.
- Scribing notches.
- Thick edge is useful as a saw guide.
- Blade length 18 cm



## Quick Clamp QC



Model #520303

Compact and user-friendly quick clamp with a one-hand grip and a clamping force of up to 90 kg. Steel rail forged in one piece, with a slim front jaw for increased access in narrow spaces. Pressure plates with tracked rubber pads to protect the surface and provide an increased clamping force.

- Slim front jaw for increased access in narrow spaces
- Quick and easy clamping operations
- Reversible head enabling both internal and external attachment
- Clamping force of up to 90 kg
- End protection with a hole for hanging

Weight	Throat Depth	Description	Model #
1.56lb / 710g	2.95" / 75mm	QUICK CLAMP QC 30	520303
1.87lb / 850g	2.95" / 75mm	QUICK CLAMP QC 45	520453

## Screw Clamp CM



Model #524303

A strong clamp with jaws of impact resistant malleable castings and a wooden handle. Profiled rail of nickel and chrome plated steel with grooves on both sides to prevent the slider from slipping at fixation. Strong flat threaded, black dyeing screw with tilted pressure plate and plastic protective caps.

- Profiled and ribbed steel rail.
- Anvil with plastic protection caps.
- Tilted pressure plate.
- Jaw with support foot.
- Clamping force up to 500 kg.

Weight	Throat Depth	Description	Model #
3.5lb / 1600g	4.72" / 120mm	MOLDED SCREW CLAMP CM 30-12	524303
4.5lb / 2050g	4.72" / 140mm	MOLDED SCREW CLAMP CM 30-14	524313
4.3lb / 1950g	4.72" / 120mm	MOLDED SCREW CLAMP CM 50-12	524503

## Ratchet Clamp RC



Model #525383

One-hand clamp with ratchet function allows different clamping forces. Fiberglass reinforced nylon with 2-component handles and plastic pressure plates.

- Swivel pressure plates.
- Ratchet function.
- Friction grip.

Weight	Throat Depth	Description	Model #
0.17lb / 80g	1.25" / 32mm	RATCHET CLAMP RC 38	525383
0.44lb / 200g	2.17" / 55mm	RATCHET CLAMP RC 58	525583

## Chalk Line CLP



Model #652113

Chalk line with 30 m line, metal crank and quick gear function 3:1. The house is manufactured in ABS plastic with a big opening for refilling and a cap with bayonet joint. Contains 100g of chalk. The line is braided cotton/polyester - with high absorbing chalk capacity - considerable increased numbers of distinct lines, up to 10 lines.

- Overload protection reducing the risk for damaging the gear mechanism and the line to break.
- Release function in open and closed crank position. (Crank will not spin when pulling out line).
- Braided line with high absorbing chalk capacity - considerable increased numbers of distinct lines.
- Gear function 3:1, rewinds the line 3 times faster.
- The cap is divisible, makes it simple to replace the line.

## Chalk Line Chalk Blue



Model #652523

This blue chalk is the most widely used chalk. It can be used for both indoor and outdoor work.

- Pigment-rich, producing clear and long-lasting lines.
- The chalk is finely milled and effectively attaches to the cord.
- Contains dolomite and ultramarine.

## Chalk Line Chalk high-vis



Model #652733

Model #652833

This neon green and neon orange chalk produces very clear lines. Can be used for both indoor and outdoor work.

- Produces strong, clear lines.
- The chalk is finely milled and effectively attaches to the cord.
- Pigment-rich, producing clear and long-lasting lines.

Description	Model #
MARKING CHALK HIGH VIZ GREEN 200	652733
MARKING CHALK HIGH VIZ ORANGE 200	652833



## Spare Line RCL 30

Spare line for Chalkline CLP. By replacing a worn out line to a new, you prolong the life span of the CLP. It is a Sustainable Choice that is better for the environment.



Model #652133

Fits to	Description	Model #
652113	SPARELINE RCL 30	652133





# A unique product family

HULTAFORS **GROUP** offers a dynamic range of premium brands to rely on - for distributors and professionals alike. Each brand within the Group is united with a common passion: to keep tradesmen at the forefront in terms of functionality, safety, protection and overall productivity.

Hultafors Groups is proud to present eight leading brands that together offer a unique product family for professionals.

Each brand represents expertise in its particular area and brings unparalleled knowledge and insight into the unique on-the-job challenges encountered by professionals. This makes it possible for us to meet, even anticipate, evolving demands by designing innovative

state-of-the-art products that make the tradesmen's workday safer, easier and more productive.

Excelling in brand-driven product categories within the construction industry and equipment sectors, we offer customers and users a best-in-class experience. And by using our high-value products as well as benefitting from brands built around their needs, tradesmen can be at the forefront every day and take great pride in their work.

## **Snickers Workwear**

- INVENTING WORKWEAR.

Snickers Workwear is one of the leading brands in the workwear industry in Europe. Workwear for craftsmen who want the ultimate in on-the-job safety, protection and functionality.

## **Dunderdon**

- THE PRODUCT MAKES THE BRAND.

Always offering honest, timeless and casual design. Dunderdon's products represent the highest craftsmanship and innovation, while never compromising on fit and style.

## **Johnson Level**

- JOB SITE TOUGH.

Johnson Level offers a complete range of levels, lasers and measuring tools to help professional users do their work more accurately, quickly and reliably.

## **Hultafors**

- TOOLS TO RELY ON.

Hultafors is a leading international brand offering innovative state-of-the-art hand tools with the best possible functionality, precision and reliability. Designed for construction and industry.

## **Hellberg**

- WHEN HEARING MATTERS.

Hellberg Safety develop and supply hearing protection, face protection and communication solutions for all people exposed to excessive noise at work.

## **Toe Guard**

- SAFETY WITHOUT COMPROMISE.

The Toe Guard brand represents safety without compromise, timeless design and affordable products. Our aim is to offer great products at competitive prices.

## **Wibe Ladders**

- SAFETY IN EVERY STEP.

Wibe Ladders is the leading Nordic manufacturer of innovative tradesmen's ladders, trestle steps and scaffolding that help trade professionals work more safely and efficiently.

## **Solid Gear**

- ONE STEP AHEAD.

Solid Gear provides utility footwear for professional workers. We insist on nothing less than perfection and make sure that every detail counts. Step into our shoes and experience true passion for shoe making.

[hultaforsgroup.com](http://hultaforsgroup.com)

**Snickers**  
WORKWEAR

**Hultafors**

**wibe**  
LADDERS

**DUNDERDON**



**Hellberg**

**SOLID GEAR**

**JOHNSON**

**TOE GUARD**

**HULTAFORS GROUP**





Retailer:

---

13 Wood Islands Road  
Lower Montague, PE, Canada, COA 1R0  
info@atlanticsafetywear.com  
1-902-846-9277  
atlanticsafetywear.com

Distributor

